

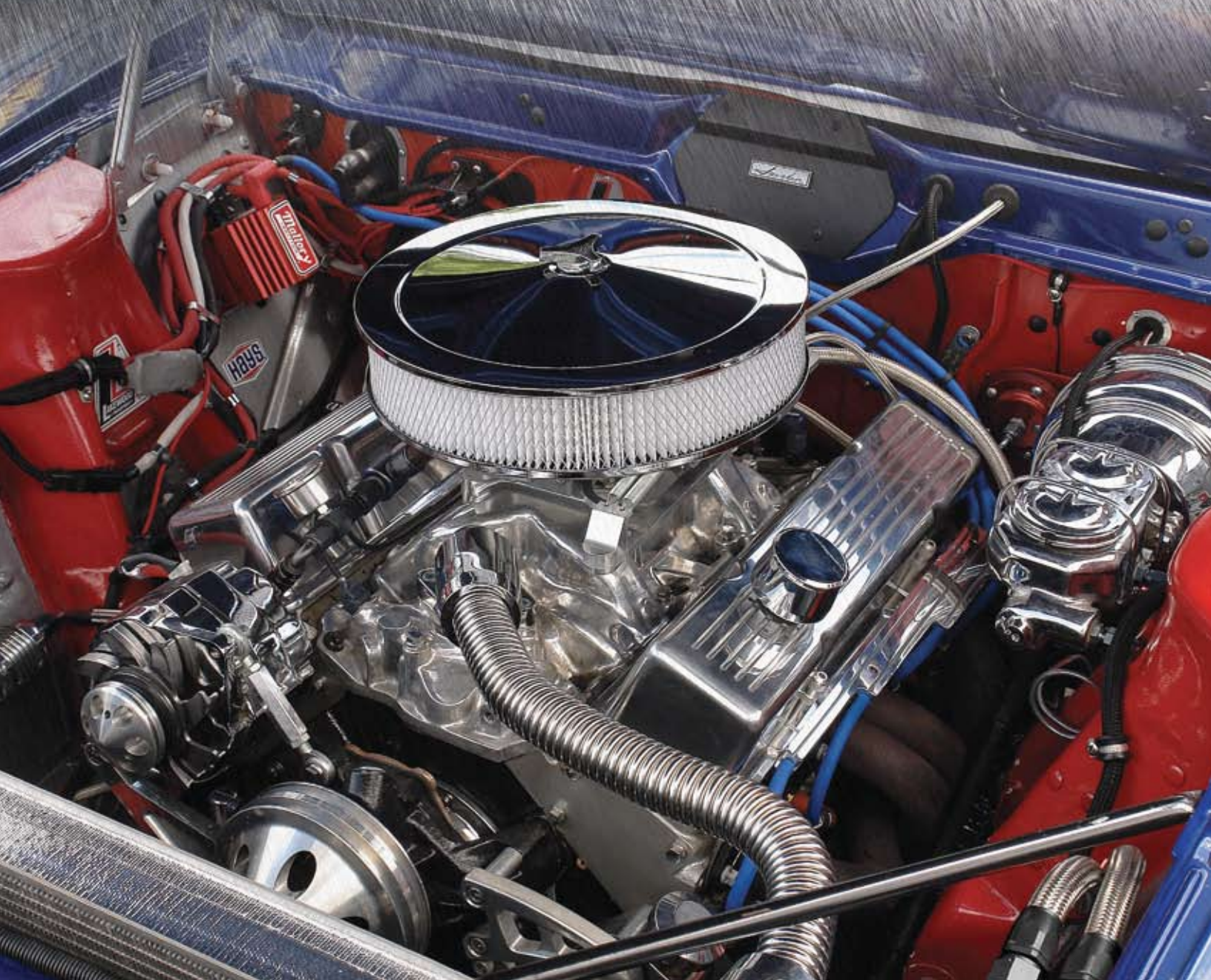

# **PERFORMANCE ACCESSORIES 2010 SUPPLEMENT**



**6820G**  
**SBC Fab Aluminum Valve Covers**

- One hole each side
- Billet rails
- Hardware included
- Baffled



**6822G**  
**BBC Fab Aluminum Valve Covers**

- One hole each side
- Billet rails
- Hardware included
- Baffled



**6824G**  
**SBF Fab Aluminum Valve Covers**

- One hole each side
- Billet rails
- Hardware included
- Baffled



**6840G**  
**SB Ford Tall V/C Polished Aluminum**

- Smooth polished finish
- One hole each side
- Baffled



**6870G**  
**SB Chevy 1987-97 Tall Center Bolt V/C Polished Aluminum**

- Smooth polished finish
- One hole each side
- Baffled



**6894G**  
**SBC 1958-86 Tall V/C Polished Aluminum**

- Ball milled
- One hole each side
- Baffled



**6771**  
**SB Chevy 58-86 Tall V/C Polished Aluminum**

- Oval track design
- 1-3/8" tubes one side
- Baffled
- 3-1/16" tall



**586G**  
**BB Chevy Valve Cover Gaskets**

- Rubber with steel core
- Reusable



**585G****SB Chevy Valve Cover Gaskets**

- Molded rubber with steel core
- 3/16" thick
- Reusable

**5859G****SB Ford Valve Cover Gaskets**

- Rubber with steel core
- 3/16" thick
- Reusable

**2180****Chrome Breather, Clamp-On Filter 1-3/8" Tube**

- High performance breather
- Washable
- Shielded

**2181****Chrome Breather, Clamp-On Filter 1-3/8"**

- High performance breather
- Washable

**2192****Chrome Breather, Push-In Shorty Style Filter Openings 1-1/4"**

- Shorty - 2"
- High performance breather
- Washable

**9090****Push-In Oil Cap Polished Aluminum**

- Smooth polished finish
- Plug style oil cap
- Grommet *NOT* included
- Fits 1-1/4" openings

**3701****Vacuum Canister Black Painted**

- Improve power brake performance

**9186G****Breather Oval Push-in Polished Aluminum**

- Polished aluminum
- Finned design
- Fits 1-1/4" openings

**5115****Inspection Cover TH 350/400**

- Heavy gauge steel
- Chrome plated

**5135****Flywheel Dust Shield GM 700R4 Chrome**

- Chromed steel
- Easy bolt up



**9705G**  
**Oil Dipstick 1980-85 SBC**  
**Polished Aluminum/Braided SS**

- Billet aluminum handle
- Flexible
- Bolts to block from inside headers



**9706G**  
**Oil Dipstick 1955-1979 SBC**  
**Polished Aluminum/Braided SS**

- Billet aluminum handle
- Flexible
- Bolts to block from inside headers



**9707G**  
**Oil Dipstick BBC Flexible**  
**Aluminum Braided**

- Billet aluminum handle
- Flexible
- Bolts to block from inside headers



**9703G**  
**Transmission Dipstick GM Turbo 350**  
**Polished Aluminum/Braided SS**

- Billet aluminum handle
- Flexible
- Firewall mount



**9779K**  
**Oil Pan 1965-90 BBC Black Painted**

- Stock capacity (4 QT) OE style pan
- Baffled
- Passenger side dipstick
- Black painted
- Will not fit Chevelle with steering behind crossmember, V8 Vega/Monza or 62-67 Chevy and some Corvettes



**9704G**  
**Transmission Dipstick 700R4**  
**Firewall Mount Braided SS**

- Billet aluminum handle
- Flexible
- Firewall mount



**9779P**  
**Oil Pan 1965-90 BBC Unplated**

- Stock capacity (4 QT) OE style pan
- Baffled
- Passenger side dipstick
- Unplated
- Will not fit Chevelle with steering behind crossmember, V8 Vega/Monza or 62-67 Chevy and some Corvettes



**9791G**  
**Trans Pan GM Turbo 350 Polished Aluminum**

- Finned for increased cooling



**9780P**  
**Oil Pan 1965-87 SBF Unplated**

- Stock capacity OE style pan
- Car applications only, *NO TRUCKS*
- Will *NOT* fit Mustang II

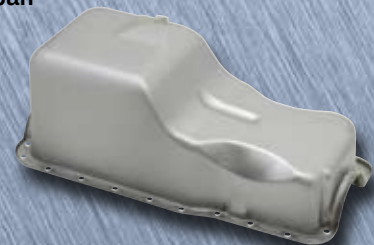

**11014P**  
**48" Stainless Steel Radiator Hose Chrome**

- Includes stainless steel hose, rubber reducers/adapters, 4 hose clamps and polished end cap covers



**1450A**  
**14" x 5" Round Paper A/C Element**

- High flow design
- 14" diameter by 5" height



**1990G**  
**Fan Shroud Bolt Kit**

- Universal fan or fan shroud mount kit
- Includes nylon hardware, washers and wing nuts

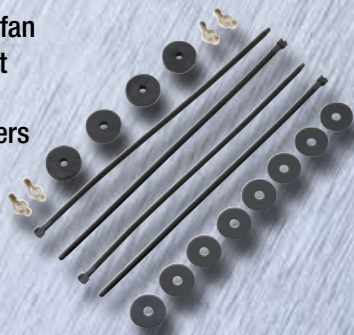

**4595P**  
**SBC 283-350 Timing Cover Unplated**

- Unfinished
- Steel construction
- Cover only, gasket and hardware sold separately



**4948G**  
**Power Steering Pulley Early GM Single Groove**

- Fits early GM and Chevy 1976-84 with keyway and 5/8" shaft
- 5-3/4" OD



**4961G**  
**Crankshaft Pulley BBC 396-454 Triple Groove LWP Chrome**

- Chromed steel construction
- 7.80" OD



**5181G**  
**Radiator Support 1970-81 Camaro Heavy Duty Chrome**

- 3 bolts
- 28-1/16" x 5-1/2"
- GM #14015198



**5183G**  
**Radiator Support 1968-77 Chevelle Heavy Duty Chrome**

- 4 bolt
- 31-3/8" x 5-3/4"
- GM #354021



**6055**  
**Ford Coil Bracket Only, Chrome**

- Chromed steel construction
- Fits most cylindrical coils
- Coil *NOT* included



**6092**  
**Stainless Steel Throttle Cable Bracket**

- Dual spring included



**3439**  
**Carburetor Spacer 1/2" Phenolic**

- Phenolic material isolates carb from excess heat
- Open design
- Hardware included



**6798**  
**1967-81 Camaro Hood Latch Chrome**

- Chromed safety style hood latch kit
- Hardware included



**7631**  
**SBC Manifold E.G.R. Block Off Plate Chrome**

- Chromed steel construction
- Gasket and hardware included



**5659**  
**Universal Throttle Cable Braided SS**

- 36" length overall
- Flexible



**9133**  
**Radiator Overflow Tank SS 3" x 10"**

- 34 oz. capacity
- Mounting hardware included



**9135**  
**Radiator Fluid Reservoir Stainless**

- 24 oz. capacity
- Mounting hardware included



**7365G**  
**Dual Pass Transmission Cooler**  
**Satin Aluminum**

- 12" length
- Dual pass design
- Easy installation
- Finned for increased cooling



**8217G**  
**4" Peep Mirror - Show Stainless**

- Polished stainless steel construction
- 4" diameter for easy fit



**8218G**  
**4" Swan Neck Mirror Street Stainless**

- Polished stainless steel construction
- Classic style "swan neck" mounting arms



**8219G**  
**Turn Signal Light Chrome**

- Sold individually
- 1-3/4"W x 1-1/8"H x 1-5/8"D



**5400**  
**3" Header Reducers Zinc Plated**

- Heavy duty header reducers
- 3"-3 hole flange
- Hardware *NOT* included



**9210G**  
**Firewall Mount Gas Pedal, Chrome**

- "Spoon" style pedal
- Firewall mount
- Chromed steel construction



**1988**  
**16" Electric Fan - Reversible**

- High torque, low amp draw
- Dual ball bearings for better wear
- Reversible fan blades engineered to provide maximum air flow



**2470S (13 Psi)**  
**2471S (16 Psi)**

- Indicates coolant temperature
- Helps prevent injuries caused by hot coolant
- Integrated coolant reclamation/overflow valve
- Fahrenheit and Centigrade readings





## ***MR. GASKET IS YOUR BEST CHOICE FOR PERFORMANCE ACCESSORIES***

- Brand name recognition, the originator of performance dress products since 1964
- Better quality product for better fit and function
- Takes up less space in displays so you can fit more product
- Combine shipping with other Mr. Gasket brands



Mr. Gasket is a trademark of Prestolite Performance  
Cleveland, Ohio  
[www.mr-gasket.com](http://www.mr-gasket.com)

©2010

74490G

